

MOTE & ASSOCIATES, INC

Commercial Real Estate for Southwest Dallas

For Sale

±4.98 Acre Lot

6500 S. Westmoreland Road, Dallas



SALES PRICE:

\$323,224.00
\$1.49 SF

ZONING:

NEIGHBORHOOD
OFFICE DISTRICT

MAPSCO:

63-N

PROPERTY FEATURES:

- +/-4.98 ACRE LOT
- UTILITIES AVAILABLE
- HIGH VISIBILITY FROM WESTMORELAND RD.
- IRREGULAR SHAPED LOT
- +/-811' FRONTAGE ON WESTMORELAND RD.
- NWQ OF I-20 AND HWY 67
- ON THE EAST SIDE OF WESTMORELAND ROAD,
BETWEEN CAMP WISDOM AND RED BIRD LANE

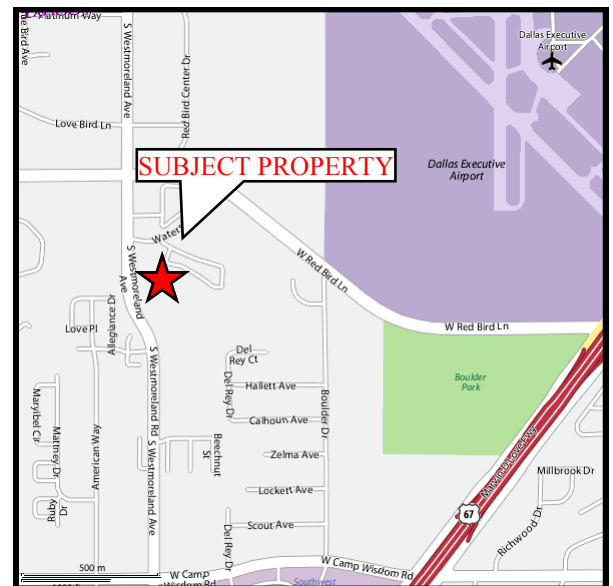

Offered for sale exclusively by:

Mote & Associates, Inc.

Contact: Bill Mote

515 N. Cedar Ridge, Suite 9 • Duncanville, Texas 75116

972-296-2856 • fax 972-709-4170

bmote@moteandassociates.com

All information has been obtained from a source deemed reliable but is not guaranteed, and broker makes no warranties of any kind with respect to accuracy of such information. All square footage/acreage is based on information obtained from county data records. Price subject to change without notice.

MOTE & ASSOCIATES, INC

Commercial Real Estate for Southwest Dallas

For Sale

Aerial

6500 S. Westmoreland Road, Dallas



Offered for sale exclusively by:

Mote & Associates, Inc.

Contact: Bill Mote

515 N. Cedar Ridge, Suite 9 • Duncanville, Texas 75116

972-296-2856 • fax 972-709-4170

bmote@moteandassociates.com

All information has been obtained from a source deemed reliable but is not guaranteed, and broker makes no warranties of any kind with respect to accuracy of such information. All square footage/acreage is based on information obtained from county data records. Price subject to change without notice.

